



V-Till® offers a more affordable alternative for those tillage applications that require total loosening and do not need coulters. For decades the V-Frame configuration has been widely a accepted design. Bigham combines the proven advantages of tillage with award winning Paratill® Legs and a popular frame style.

Standard Features:

- Heavy duty V- Frame is constructed from 7 x 7 x 3/8” tube. Heavy welded Leg clamps space legs at optimum 26” point centers for a consistent tillage across the width of the frame. Heavy Category III wide hitch is standard on all models.
- Each Paratill Leg is protected by six high quality replaceable wear surface parts. Each clamp is equipped with a shear bolt to prevent damage when rocks or other obstructions are encountered.
- Extra Heavy Duty Gauge Wheels are included with both models. Eight Leg machines include duals; Six Leg machines have singles.



Try a V-Till. In the picture above a traditional V-ripper with parabolic shanks operated on the right side. Several trips will be required to prepare this land for planting. A Paratill® was run on the left side next to the ripper. Which condition would you rather see in your fields?

P/N	Description	Transport Width	Frame Depth From Hitch Pin	Number of Legs	Tillage Width	Approx. Ship Wt.
907-606	V-Till®, 6 Leg 7x7”	14’7”	70”	6	12’3”	2875 Lbs.
907-608	V-Till®, 8 Leg 7x7”	17’8”	85”	8	16’6”	3550 Lbs.

V-Tills® include: V-Frame constructed with 7 x 7” tube, Leg brackets, hitch and gauge wheel mounting boxes, Cat. III 4” drop hitch assembly., corresponding quantities of Legs with wear parts as specified, and extra heavy duty gauge wheels with 9.5L Tires (single gauge wheels with six leg units, dual gauge wheels with eight Leg units). Bolt on frame extensions are supplied with eight Leg Plows All units are priced unassembled, F.O.B. Lubbock, Texas.



Lubbock, Texas (800) 692-4449
 Carlisle, Arkansas (870) 552-7517
www.BighamAg.com

V-Till® (Parts Breakdown)

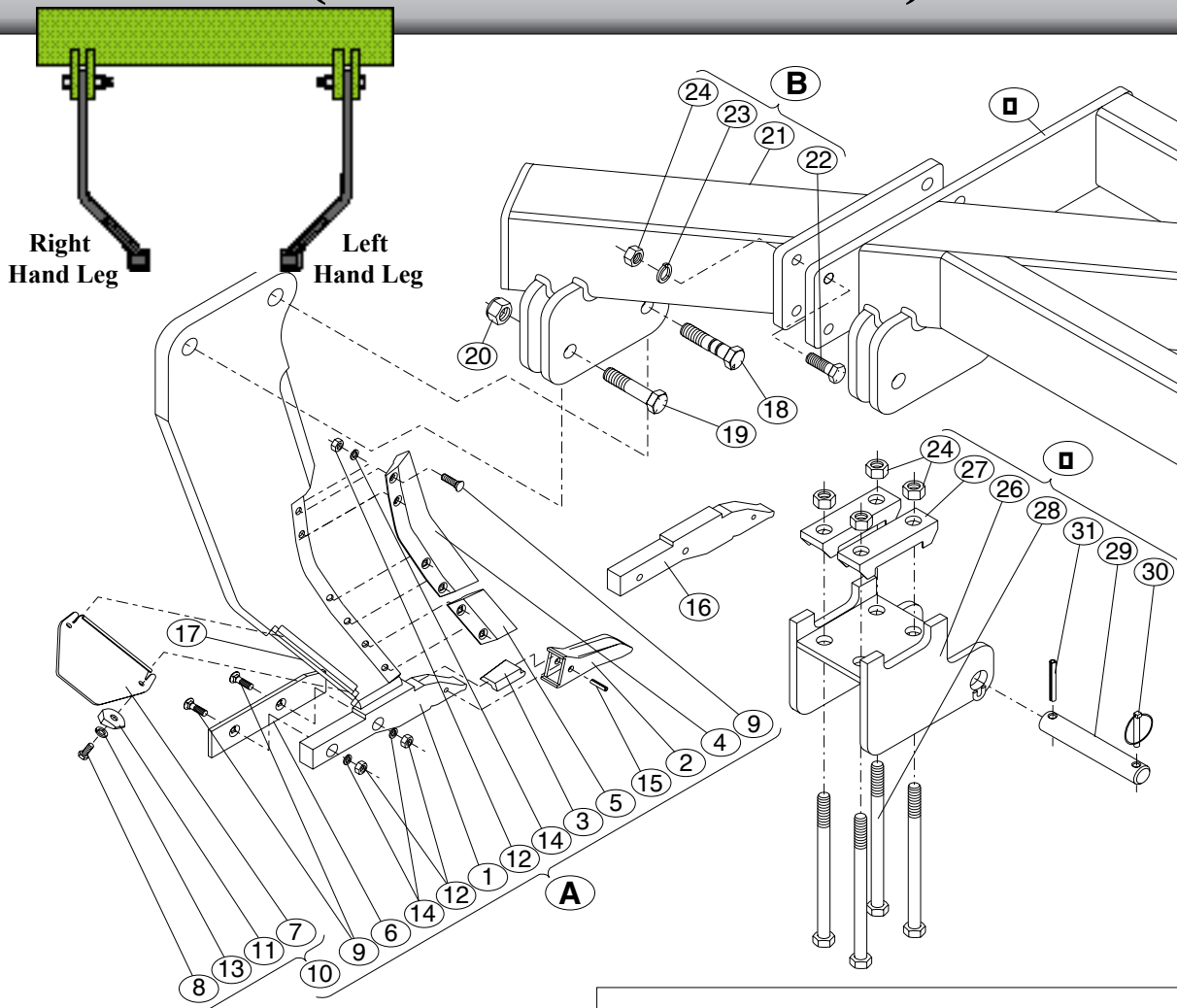

Ref.#	P/N	Description	Qty. Req. Per Assy. * = LH or RH
A.	709-060	Leg Assy., LH Complete	
	709-061	Leg Assy., RH Complete (Pictured)	
1.	681-067	Foot, Replacement RH	-
2.	681-002	Point (Knock-on) Ductile ADI	-
	681-002HF	Point (Knock-on) Chromium Carbide ¹	
3.	681-003L	Instep, LH	*1
	681-003R	Instep, RH	*1
4.	681-004L	Upper Shin, LH	*1
	681-004R	Upper Shin, RH	*1
5.	681-005L	Lower Shin, LH	*1
	681-005R	Lower Shin, RH	*1
6.	681-006	Landslide (Alloy)	1
7.	681-007	Shatter Plate Blade (Universal)	2
8.	681-008	Bolt, HCS GR8.8 12 x 20mm	1
9.	681-009	Bolt, Plow GR12.9 10 x 35mm	8
10.	681-020	Shatter Plate Assy., (Universal)	1
11.	681-011	Nut, Concentric (Shatter Adj.)	1
12.	681-012	Nut, Hex GR12.9 10mm	8
13.	681-013	Washer, Lock 12mm	1
14.	681-014	Washer, Lock 10mm	8
15.	681-015	Pin, Roll 8 x 60mm	1
16.	681-066	Foot, Replacement LH	-

Ref.#	P/N	Description	Qty. Req. Per Assy. * = LH or RH
17.	681-094	Rod, Shatter Plate	-
18.	610-1822Z	Shear Bolt, ZP 1-1/8 x 5-1/2"	1
19.	602-1822Z	Bolt, HCS ZP GR5 1-1/8 x 5-1/2"	1
20.	613-1800Z	Nut, Hex Nylock ZP 1-1/8"	2
B.	814-975	Extension Assy., V-Till® LH (Pictured)	-
	814-976	Extension Assy., V-Till® RH	-
21.	707-976	Extension Weldment, V-Till® LH (Pictured)	*1
	707-977	Extension Weldment, V-Till® RH	*1
22.	602-1614Z	Bolt, HCS ZP GR5 1 x 3-1/2"	4
23.	615-1600	Washer, Lock 1"	4
24.	611-1601Z	Nut, Hex ZP 1"	4
C.	701-776	V-Frame 7 x 7 x 3/8" 6 Leg V-Till®	1
D.	804-507	Pull Point Assy., Cat. III/4" Drop 7 x 4"	2
26.	704-450	Pull Point Wlmt. Cat. III/4" Drop 4" Bar	1
27.	628-400	Cap, 4" Bar 7/8 & 1" Bolt Holes	2
28.	602-1640Z	Bolt, HCS ZP GR5 1 x 10"	4
29.	617-196	Pin, Clevis Cat. III Wide P.P.	1
30.	617-105	Klick Pin, 7/16 x 2"	1
31.	617-053	Pin, Roll 7/16 x 2-1/4"	1
Gauge Wheel Assemblies:			
	805-755	Gauge Wheels, XHD 7 x 5" 9.5L Tires	
	805-756	Gauge Wheels, XHD Duals 7x5" 9.5L Tires	
See catalog page C-1 for detailed parts list of gauge wheels.			