

Special Application Gauge Wheels

Bigham offers a complete line of depth control gauge wheels for virtually any application. All of these gauge wheels feature six hole Q888 hubs with 2" spindles. Hub and axle static load capacity is rated at 3500 lbs. per hub. Heavy mounting assemblies and screw jacks complement most of the gauge wheel assemblies listed. Standard mount packages are listed for 4x4 tool bars. Mount brackets are available for any size frame. Bigham can custom build gauge wheels to your specifications. Please call for a quote.

Low Profile (Paratill®) Gauge Wheels

Low profile gauge wheels have a smaller diameter wheel and tire assembly in order to provide depth control under the frame for most tillage applications. Compact turnbuckle jack assembly is designed to complement the underframe application. These are supplied as standard equipment on all Paratills® and TerraTills®.



P/N	Description	Approx. Ship Wt.
805-205	Gauge Wheels, 4x4" (Paratill®) 195 Lbs. Low Profile Gauge Wheels include two mount assemblies, two turnbuckle screw jacks, one left and one right arm/hub assembly and two wheel/tire assemblies (20.5x8).	

Modular Gauge Wheels

Modular Gauge Wheels also feature the same low profile wheel and tire assembly (20.5 x 8") but with a mounting attachment that couples the tire closer to the attaching frame. Modular mount has right and left plates which may be switched in position for mounting flexibility. Mount plate bolts are tightened in order to maintain height adjustment. Arm and hub may be placed at vertical or at 16° slant from vertical. Modular gauge wheels are standard equipment for Mechanical Trip Paratills®.



P/N	Description	Approx. Ship Wt.
805-444	Modular Gauge Wheels, 4x4" 165 Lbs. Modular Gauge Wheels include two mount assemblies, two arm/hub assemblies and two wheel/tire assemblies (20.5x8).	

Extended Arm Gauge Wheels

(Disc Bedder) HD & XHD

Extended Arm Gauge Wheels will furnish extra clearance to the front of the tool bar. Gauge wheel arm is constructed at 30" length in lieu of 24" like our standard gauge wheels. The extra clearance shifts tire away from attachments which extrude to the front of the tool bar or for those applications which require maximum ground clearance. Extended arm gauge wheels are available in standard (2x4 arm) or Extra Heavy Duty (4x4 arm) selections for virtually any size bar. Extended arm gauge wheels are standard equipment for Disc Bedders.

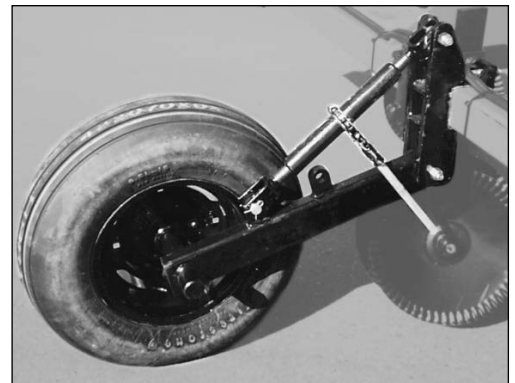

P/N	Description	Approx. Ship Wt.
805-449	GW Std. w/9.5L 30" Arm 4x4"	355 Lbs.
805-450	GW XHD w/9.5L 30" Arm 4x4"	450 Lbs.
Extended Arm Gauge Wheels include two mount assemblies, two ratchet screw jacks, one left and one right arm/hub assembly (30") and two wheel/tire assemblies (9.5Lx15").		

Hobble Gauge Wheels

Special conditions when traffic middles are inconsistent are a perfect application for Hobble Gauge Wheels. Planters, listers and cultivators in operation through fields with reservoirs placed in the furrows may be protected from bounce and vibration. Load is distributed from one wheel to the next through ball sockets attached to each gauge wheel arm.



P/N	Description	Approx. Ship Wt.
805-452	Hobble Gauge Wheels, 4x4"	100 Lbs.
Hobble Gauge Wheels include six mount assemblies, Two ratchet screw jacks, two tie brackets, two left and two right arm/hub assemblies and four wheel/tire assemblies (9.5L x 15).		



Lubbock, Texas (800) 692-4449
 Carlisle, Arkansas (870) 552-7517
www.BighamAg.com

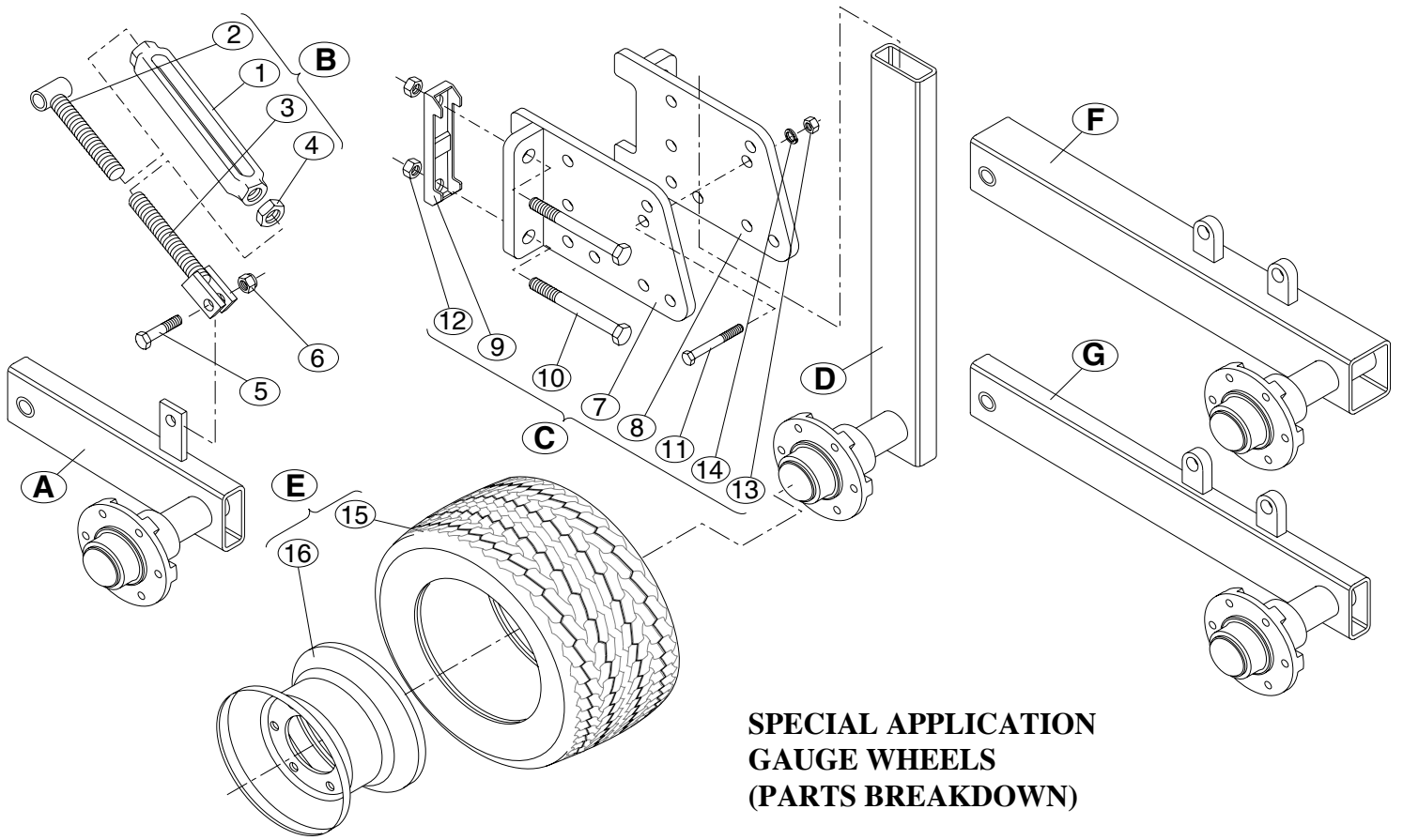

**SPECIAL APPLICATION
GAUGE WHEELS
(PARTS BREAKDOWN)**

REF#	P/N	DESCRIPTION	QTY REQ. PER SET
A.	705-022L	SHANK/HUB ASSY,LH (P-TILL)	1
	705-022R	SHANK/HUB ASSY,RH (P-TILL) PICT.	1
	705-021L	SHANK/SPINDLE, LH (P-TILL GW)	-
	705-021R	SHANK/SPINDLE, RH (P-TILL GW)	-
B.	705-087	TURNBUCKLE ASSY,P-TILL G.WHL.	2
1.	301-350	BODY,TURNBUCKLE 1 x 6" ZP	-
2.	617-094	STUD,1 x 5-3/4" LH W/BUSHING ZP	-
3.	617-095	STUD,1 x 5-3/4" RH W/EARS ZP	-
4.	614-1601Z	NUT,HEX JAM 1" ZP	-
5.	601-1011Z	BOLT,HCS 5/8 x 2-3/4" (GR2) ZP	2
6.	613-1005Z	NUT,HEX NYLOCK ZP 5/8"	2
C.	805-110	MOUNT ASSY.,4x4 MODULAR GA.WHL	-
7.	705-048	MOUNT PLT, LH MODULAR GW 4"	1
8.	705-049	MOUNT PLT, RH MODULAR GW 4"	1
9.	628-200	CAP, 4" 3/4 BOLT HOLES (CAST)	2

REF#	P/N	DESCRIPTION	QTY REQ. PER SET
10.	601-1228Z	BOLT,HCS 3/4 x 7" (GR2) ZP	2
11.	602-0815Z	BOLT,HCS 1/2 x 3-3/4" (GR5) ZP	4
12.	611-1201Z	NUT,HEX ZP 3/4"	4
13.	611-0801Z	NUT,HEX ZP 1/2"	4
14.	615-0800Z	WSHR, LOCK ZP 1/2"	4
D.	705-025	SHANK/HUB ASSY.,MOD. GA. WHL.	2
	705-024	SHANK/SPINDLE,MOD. G.W.2 x 4 x 29"	-
E.	705-006	WHEEL & TIRE,6HOLE 20.5 x 8.0-10	2
15.	627-575	TIRE,20.5X8.0-10 PLY P-TILL GW	-
16.	627-480	WHEEL, 6 HOLE 10X6" P-TILL GW	-
F.	760-710	SHANK/HUB ASSY,LH (XHD) 30"	1
	760-711	SHANK/HUB ASSY,RH (XHD) 30"	1
	760-700	SHANK/SPINDLE XHD GW LH 30"SHK	-
	760-701	SHANK/SPINDLE XHD GW RH 30"SHK	-
G.	760-712	SHANK/HUB ASSY., LH 2 x 4 x 30"	1
	760-713	SHANK/HUB ASSY., RH 2 x 4 x 30"	1
	760-702	SHANK/SPINDLE RHD GW LH 30"SHK	-
	760-703	SHANK/SPINDLE RHD GW RH 30"SHK	-
See pages C-2 & C-3 for additional gauge wheel parts listing.			

OTHER GAUGE WHEEL CONFIGURATIONS AVAILABLE. CALL FOR DETAILS.

**BIGHAM • 705 E. SLATON ROAD • P.O. BOX 3338 • LUBBOCK, TX 79452 • (806) 745-0384
1220 EAST DURKEE STREET • CARLISLE, AR 72024 • (870) 552-7517**