

# OWNER'S MANUAL

## *Single Disc Bedder*

*SDB40 – 16 row 30 / 12 row 38*

*SDB38 – 12 row 38 / 12 row 36*

*SDB32 – 12 row 30*



1220 E Durkee Street, Carlisle, AR 72024

870-552-7517

870-552-3303

BighamAg.com

	<p><b>⚠ WARNING</b></p> <p>To Prevent Serious Injury or Death</p> <ul style="list-style-type: none"><li>• Avoid unsafe operation or maintenance.</li><li>• Do not operate or work on this machine without reading and understanding the operator's manual.</li><li>• If manual is lost, contact your nearest dealer for a new manual.</li></ul> <p>1</p>
---	--

# TABLE OF CONTENTS

WARRANTY.....	3
INTRODUCTION.....	4
SAFETY.....	5
SAFETY SIGNAL WORDS.....	5
GENERAL SAFETY GUIDELINES.....	6
SAFETY SIGN LOCATIONS.....	7
SAFETY DECAL CARE.....	10
TIRE SAFETY.....	10
LIGHTING AND MARKING.....	11
PERSONAL PROTECTIVE EQUIPMENT.....	12
BEFORE OPERATION.....	12
DURING OPERATION.....	13
HIGHWAY AND TRANSPORTATION OPERATIONS.....	14
FOLLOWING OPERATION.....	15
PERFORMING MAINTENANCE.....	16
TRANSPORT LOCK PIN.....	18
REAR STABILIZER ADJUSTMENT.....	19
WING LEVELING ADJUSTMENT.....	20
HITCH COMPONENTS.....	22
FRAME WING ASSEMBLY COMPONENTS.....	23
DISC GANG ASSEMBLIES.....	25
STABILIZING COUNTER ASSEMBLY.....	28
DIRT SHIELD ASSEMBLIES.....	29
GAUGE WHEEL ASSEMBLY.....	31
HYDRUALIC ASSEMBLIES.....	32
ROW SPACING LAYOUT.....	33

**A MESSAGE TO THE OWNER AND OPERATOR:**

This machine was carefully designed and manufactured to give you dependable service. To keep it running efficiently, read the instructions in this Operator's Manual. Check each item and acquaint yourself with the adjustments required to obtain efficient operation and maximum performance. Remember, the machines performance depends on how you operate and care for it.

After the operating season, thoroughly clean your machine and inspect it. Preventive maintenance saves time and pays dividends. Your dealer has original equipment parts which assure proper fit and best performance. Record the model number, serial number and date of purchase in the space provided on this page. Your dealer needs this information to give you efficient service when you order parts or attachments. The model number and serial number appear on the identification plate on the front left side of the tool bar mast.

The Warranty on your machine is included with this manual. Your dealer will review both this manual and the warranty with you when you take delivery of your machine.

**WARRANTY**

Bigham Ag warrants all products of its manufacture to be free from defects in materials and workmanship for a period of six months from date of delivery to the retail purchaser. Parts assumed to be defective must be returned F.O.B. Carlisle, AR for our inspection or inspected in the field by our authorized representative. Our obligation under this warranty is limited to replacement or repair of the defective part and does not cover other damages to persons or property. Other than the aforesaid, no warranties of merchantability or fitness for a particular purpose will apply. We do not assume liability for altered or remanufactured components or machines or applications beyond their intended use. Some states do not allow limitation of how long an implied warranty lasts, or exclusions of, or limitations on relief such as incidental or consequential damages, so the above limitations or exclusion may not apply to you. This warranty gives you specific legal rights and you may have other rights which vary from state to state.

Warranty does not cover damage due to abuse, neglect, collision, towing, pulling, normal wear and tear or any other factor beyond the control of the manufacturer. Tool bars that are bent, bowed or that have been welded on or modified in any way are specifically excluded from any warranties.

**Manufactured By**  
**Bigham Brothers Inc. – Carlisle, AR**

Model # \_\_\_\_\_

Serial # \_\_\_\_\_

## INTRODUCTION

Thank you for purchasing a Bigham Hipper tillage implement. We hope you will get many years of productive use from it. The Hipper can simultaneously prepare seed beds, shape furrows, and form drainage or irrigation in a single pass.

This implement is designed to be pulled by a ROPS protected tractor of proper size.

All product users must read and understand this manual prior to equipment operation. This manual is considered part of your machine and should always remain with the machine. Do not allow anyone to operate or maintain this equipment who has not fully read and comprehended this manual. Failure to follow the recommended procedures may result in personal injury or death or equipment damage.

Information in this manual is designed to help owners and operators to obtain the best results and safe operation from their investment. The life of any machine depends largely on the care it is given and we suggest that the manual should be read and understood and referred to frequently. If for any reason you do not understand the instructions and safety requirements, please contact your authorized dealer. The intent of this manual is to provide guidelines to cover general use and to assist in avoiding accidents and injuries.

There may be times when circumstances occur that are not covered in the manual. At those times it is best to use common sense and contact your authorized dealer or our factory.

The requirements of safety cannot be emphasized enough in this publication. We urge you to make safety your top priority when using and maintaining the equipment. We strongly advise that anyone allowed to operate this equipment be thoroughly trained and tested, to prove they understand the fundamentals of safe operation.

Some photographs, diagrams or illustrations in this manual may show doors, guards and shields opened or removed to aid in clarity and understanding of a particular procedure. All guards, shields and safety devices must be in their proper position prior to operation.



## SAFETY

Read and understand this manual and all safety signs before operating and maintaining. Review the safety instructions and precautions annually.

**TAKE NOTE! THIS SAFETY ALERT SYMBOL FOUND THROUGHOUT THIS MANUAL IS USED TO CALL YOUR ATTENTION TO INSTRUCTIONS INVOLVING YOUR PERSONAL SAFETY AND THE SAFETY OF OTHERS. FAILURE TO FOLLOW THESE INSTRUCTIONS CAN RESULT IN INJURY OR DEATH.**



THIS SYMBOL MEANS:

ATTENTION!



BECOME ALERT!

YOUR SAFETY IS INVOLVED!



## SAFETY SIGNAL WORDS

Note the use of the signal words **DANGER**, **WARNING** and **CAUTION** with the safety messages. The appropriate signal word for each has been selected using the following guidelines:

-  **DANGER:** Indicates an imminently hazardous situation that, if not avoided, will result in death or serious injury. This signal word is to be limited to the most extreme situations typically for machine components which, for functional purposes, cannot be guarded.
-  **WARNING:** Indicates a potentially hazardous situation that, if not avoided, could result in death or serious injury, and includes hazards that are exposed when guards are removed. It may also be used to alert against unsafe practices.
-  **CAUTION:** Indicates a potentially hazardous situation that, if not avoided, may result in minor or moderate injury. It may also be used to alert against unsafe practices.

**NOTICE** is used to address safety practices not related to personal safety.





## GENERAL SAFETY GUIDELINES

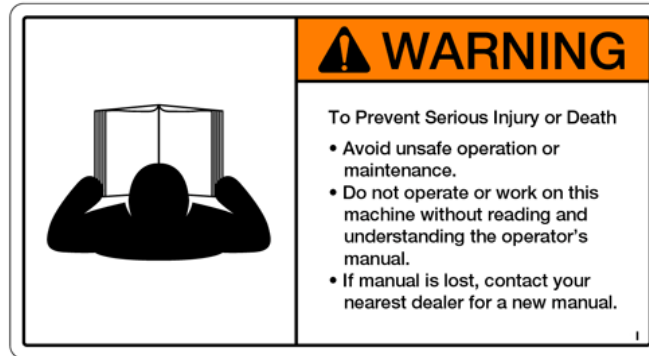

Safety of the operator and any bystanders is one of the main concerns in designing and developing a new piece of equipment. Designers and manufacturers build in as many safety features as possible. However, every year many accidents occur which could have been avoided by a few seconds of thought and a more careful approach to handling equipment. You, the operator, can avoid many accidents by observing the following precautions in this section. To avoid personal injury, study the following precautions and insist those working with you, or for you, follow them.

Replace any CAUTION, WARNING, DANGER or instruction safety decal that is not readable or is missing. Location of such decals is indicated in this booklet.

Do not attempt to operate this equipment under the influence of drugs or alcohol. Do not use the equipment if alertness or coordination is impaired.

Review the safety instructions with all users annually.

This equipment is dangerous to children and persons unfamiliar with its operation. The operator should be a responsible adult familiar with farm machinery and trained in this equipment's operations. **Do not allow persons to operate or assemble this unit until they have read this manual and have developed a thorough understanding of the safety precautions and of how it works.**

Do not read, eat, drink, talk or text or use a mobile phone while using this equipment.

To prevent injury or death, use a tractor equipped with a Roll Over Protective System (ROPS). Do not paint over, remove or deface any safety signs or warning decals on your equipment. Observe all safety signs and practice the instructions on them.

Never exceed the limits of a piece of machinery. If its ability to do a job, or to do so safely, is in question – **DO NOT TRY IT.**

Stay clear of any moving parts, such as shafts, couplings and universal joints.

Do not allow anyone to ride on any part of the equipment for any reason.

Assure that all bystanders are at a safe distance before operating or maintaining this equipment.



## SAFETY SIGN LOCATIONS

Safety Sign location is shown below.

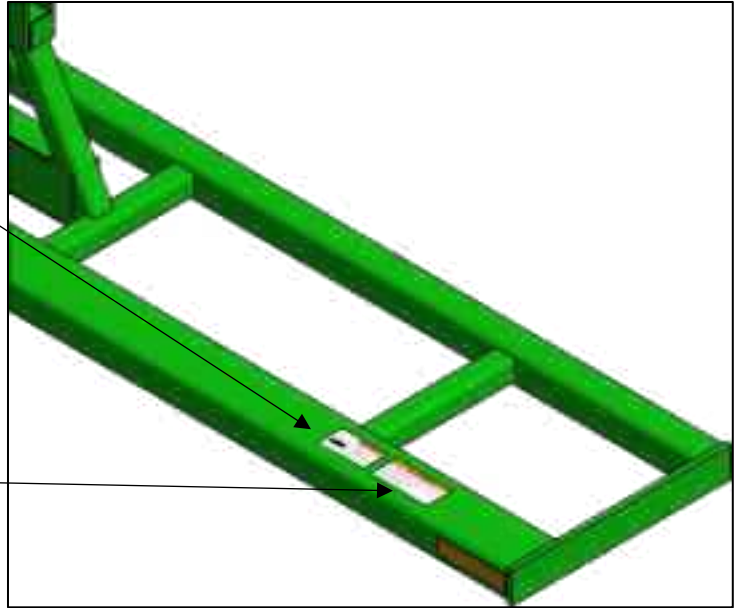
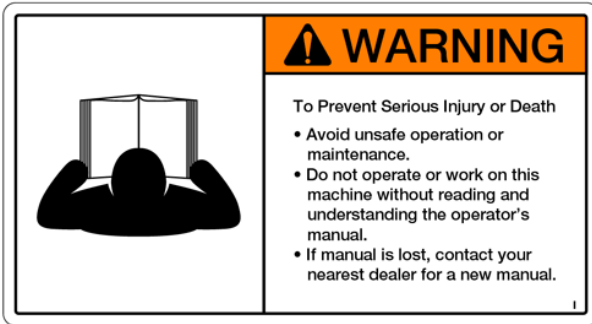

*Front of Toolbar, End of LH Wing*

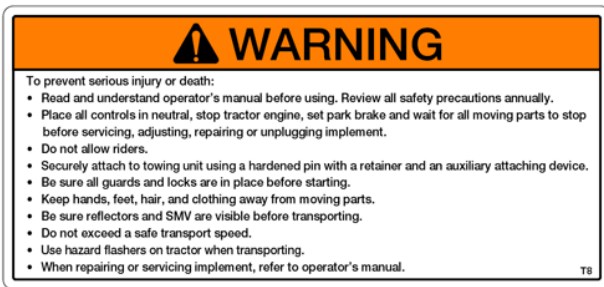

*Front of Toolbar, LH Hinge*

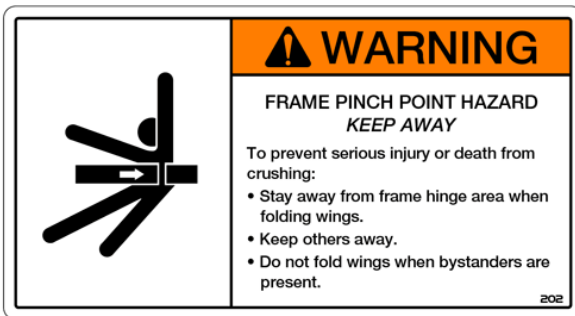

	<b>⚠ WARNING</b>
	<p><b>HIGH-PRESSURE FLUID HAZARD</b></p> <p>To prevent serious injury or death:</p> <ul style="list-style-type: none"> <li>• Relieve pressure on hydraulic system before servicing or disconnecting hoses.</li> <li>• Wear proper hand and eye protection when searching for leaks. Use wood or cardboard instead of hands.</li> <li>• Keep all components in good repair.</li> </ul>

	<b>⚠ DANGER</b>
	<p><b>CRUSHING HAZARD</b></p> <p>To prevent serious injury or death:</p> <ul style="list-style-type: none"> <li>• Do not stand between implement and moving tractor.</li> <li>• Stop tractor engine and set park brake before installing pins.</li> </ul>

<b>⚠ WARNING</b>	
<p><b>MOVING PART HAZARD</b></p>	
<p>To prevent serious injury or death from moving parts:</p> <ul style="list-style-type: none"> <li>• Close and secure guards and shields before starting.</li> <li>• Keep hand, feet, hair and clothing away from moving parts.</li> <li>• Disconnect and lockout power source before adjusting or servicing.</li> <li>• Do not stand or climb on machine when operating.</li> </ul>	
<small>406</small>	

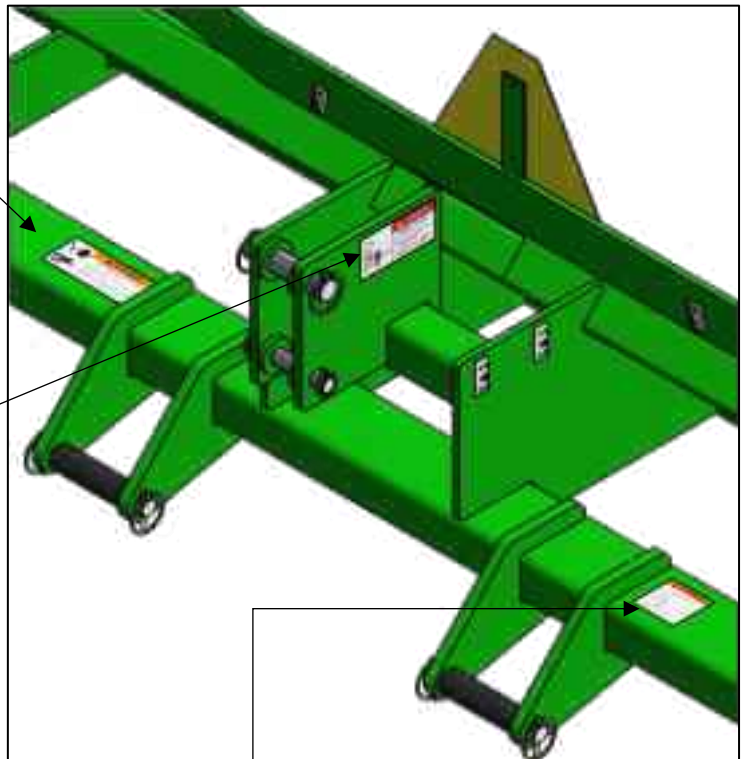

**3-Point Hitch**

	<b>⚠ DANGER</b>
	<p><b>ELECTROCUTION HAZARD</b></p> <p>To prevent serious injury or death:</p> <ul style="list-style-type: none"> <li>• Stay away from power lines when transporting, extending or folding implement.</li> <li>• Electrocution can occur without contacting power lines.</li> </ul>

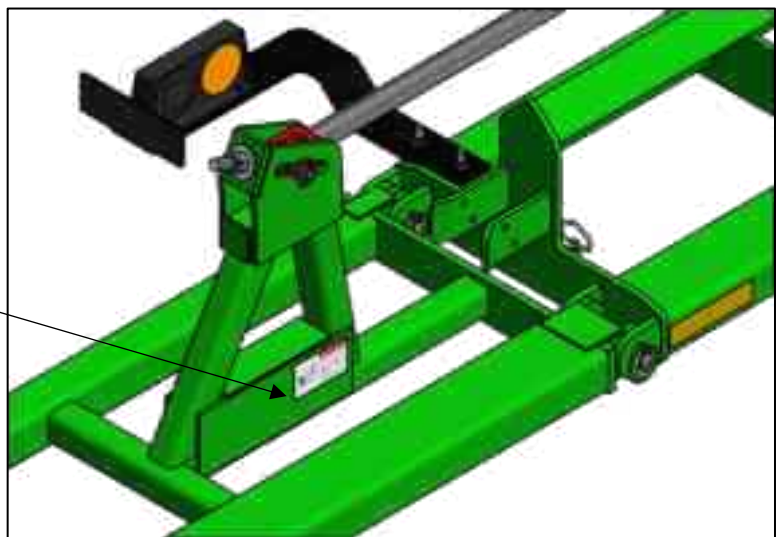

**Front of Toolbar, RH Hinge**



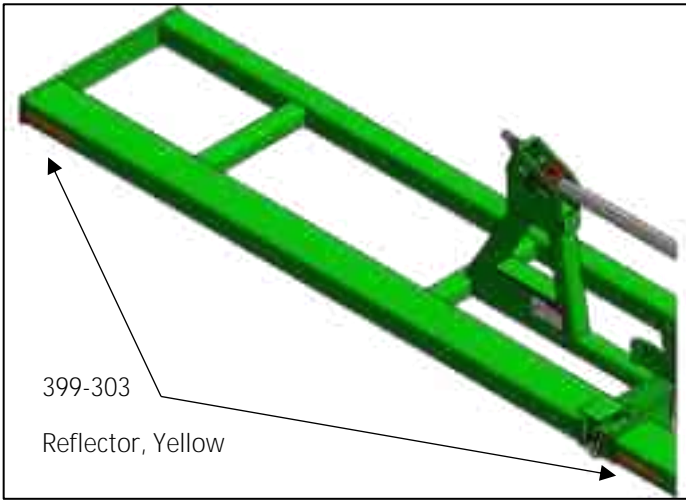

**Front of Toolbar, End of Wing & Center**

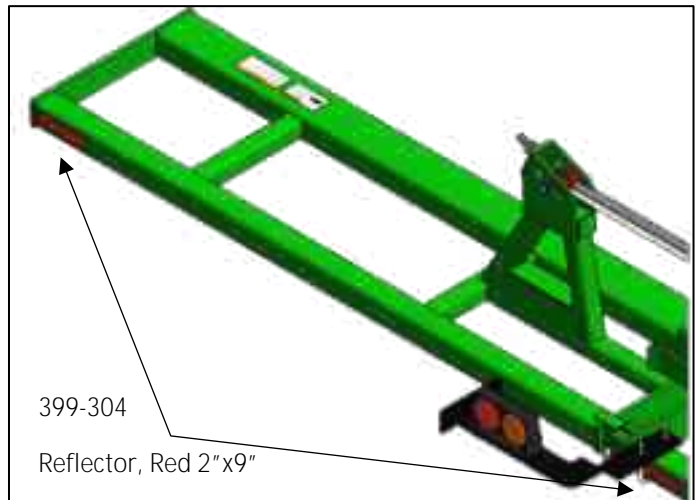

**Rear of Toolbar, End of Wing & Center**

399-300  
Sign, SMV 2-Hole Galvanized

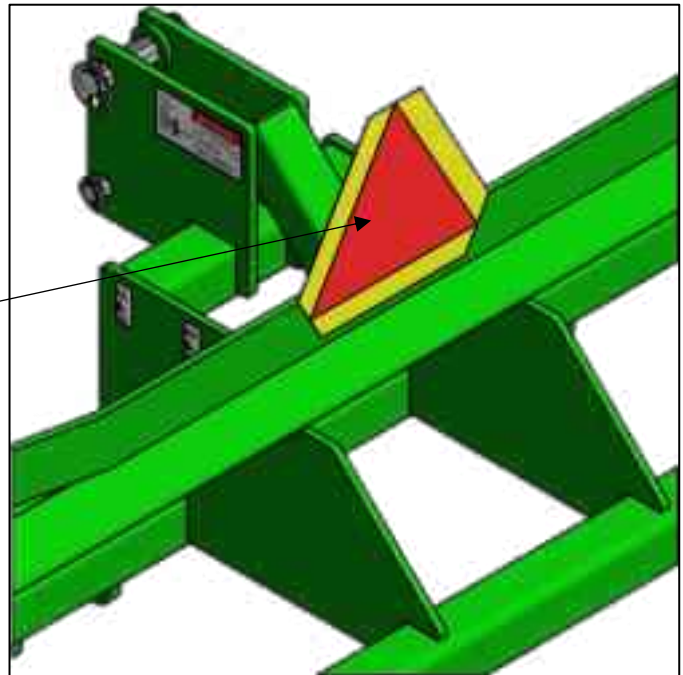

**Rear of Toolbar, Center Frame**

**REMEMBER:** If Safety Signs have been damaged, removed, become illegible or parts replaced without decals, new decals must be applied. New decals are available from your authorized distributor or factory.



## SAFETY DECAL CARE

- Keep safety signs clean and legible at all times.
- Replace safety signs that are missing or have become illegible.
- Replaced parts that displayed a safety sign should also display the current sign.
- Safety signs are available from your Distributor or Dealer Parts Department or the factory.

### How to Install Safety Signs:

- Be sure that the installation area is clean and dry.
- Decide on the exact position before you remove the backing paper.
- Remove the smallest portion of the split backing paper.
- Align the decal over the specified area and carefully press the small portion with the exposed sticky backing in place.
- Slowly peel back the remaining paper and carefully smooth the remaining portion of the decal in place.
- Small air pockets can be pierced with a pin and smoothed out using the piece of decal backing paper.



## TIRE SAFETY



- Failure to follow proper procedures when mounting a tire on a wheel or rim can produce an explosion which may result in serious injury or death.
- Do not attempt to mount a tire unless you have the proper equipment and experience to do the job.
- Inflating or servicing tires can be dangerous. Whenever possible, trained personnel should be called to service and/or mount tires.
- Always order and install tires and wheels with appropriate capacity to meet or exceed the anticipated weight to be placed on the equipment.
- Tire changing can be dangerous and should be performed by trained personnel using the correct tools and equipment.

- When inflating tires, use a clip-on chuck extension hose long enough to allow you to stand to one side NOT in front of or over the tire assembly. Use a safety cage if available.
- When removing and installing wheels, use wheel handling equipment adequate for the weight involved.
- The rims and tires should be mounted on the feeder with the valve stem to the inside. We use reverse disc rims as a protection that livestock do not step on the valve stems and break them off. Be sure you have proper tire pressure and the lug nuts are properly tightened. Check wheel bearings on a regular basis and grease semiannually.



## LIGHTING AND MARKING

- It is the responsibility of the customer to know the lighting and marking requirements of the local highway authorities and to install and maintain the equipment to provide compliance with the regulations. Add extra lights when transporting at night or during periods of limited visibility.
- Lighting kits ship standard with each unit from the Bigham factory.
- An SMV emblem ships standard on each unit from the Bigham factory. Always ensure the emblem is in place when transporting on public roadways. Keep it clean and bright.



## PERSONAL PROTECTIVE EQUIPMENT



- Wear protective clothing and equipment appropriate for the job, such as safety shoes, safety glasses, hard hat and ear plugs.
- Clothing should fit snug without fringes or pull strings to avoid entanglement with moving parts.
- Prolonged exposure to loud noise can cause hearing impairment or hearing loss. Wear suitable hearing protection such as ear muffs or earplugs.
- Operating equipment requires the operator's full attention. Avoid wearing radio headphones or earbuds while operating equipment.



## BEFORE OPERATION

- Carefully study and understand this manual.
- Do not wear loose-fitting clothing which may catch in moving parts.
- Always wear protective clothing and substantial shoes.
- Keep wheel lug nuts or bolts tightened to specified torque.
- Assure that agricultural implement tires are inflated evenly.
- Give the unit a visual inspection for any loose bolts, worn parts or cracked welds, and make necessary repairs. Follow the maintenance safety instructions included in this manual.
- Be sure that there are no tools lying on or in the equipment.
- Do not use the unit until you are sure that the area is clear, especially children and animals.
- Don't hurry the learning process or take the unit for granted. Ease into it and become familiar with your new equipment.

- Practice operation of your equipment and its attachments. Completely familiarize yourself and other operators with its operation before using.
- Use a tractor equipped with a Roll Over Protective System (ROPS) and fasten your seat belt prior to starting the engine.

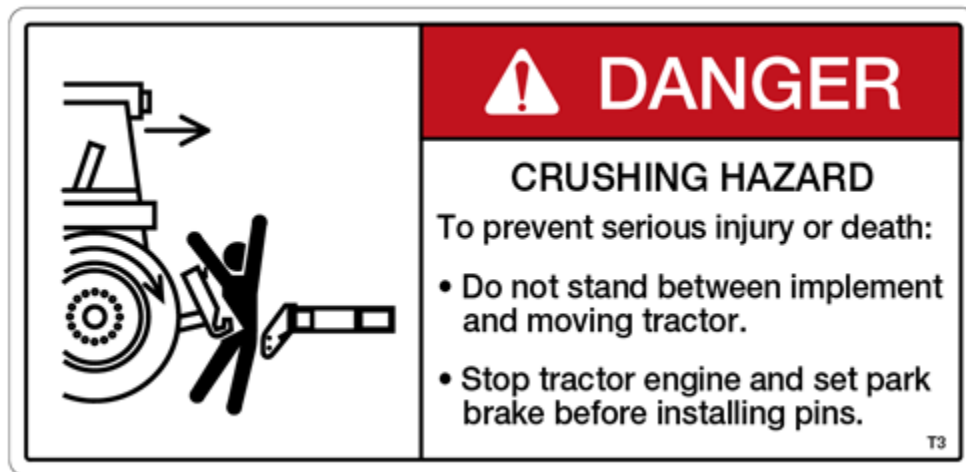

## DURING OPERATION

- Children should never be allowed on the equipment.
- Never carry riders or allow children to operate equipment.
- Clear the area of small children and bystanders before moving the equipment.
- Securely attach equipment to towing unit, using a hardened 3/4" pin, a metal retainer, and safety chains if required. Shift towing unit to a lower gear before going down steep downgrades, thus using the engine as a retarding force. Keep towing vehicle in gear at all times. Slow down for corners and rough terrain.
- Make sure you are in compliance with all local and state regulations regarding transporting equipment on public roads and highways. Lights and slow moving signs must be clean and visible by overtaking or oncoming traffic when feeder is transported.
- SAFETY CHAIN - If equipment is going to be transported on a public highway, a safety chain should be obtained and installed. Always follow state and local regulations regarding a safety chain and auxiliary lighting when towing farm equipment on a public highway. Be sure to check with local law enforcement agencies for your own particular regulations. Only a safety chain (not an elastic or nylon/plastic tow strap) should be used to retain the connection between the towing and towed machines in the event of separation of the primary attaching system.
- Install the safety chain by crossing the chains under the tongue and secure to the draw bar cage or hitch or bumper frame.
- Beware of bystanders, **particularly children!** Always look around to make sure that it is safe to start the engine of the towing vehicle or move the unit. This is particularly important with higher noise levels and quiet cabs, as you may not hear people shouting.
- **NO PASSENGERS ALLOWED** - Do not carry passengers anywhere on, or in, the tractor or equipment, except as required for operation.

- Keep hands and clothing clear of moving parts.
- Always keep all shields and guards in place and securely fastened.
- Do not clean, lubricate or adjust your equipment while it is moving.
- When halting operation, even periodically, set the tractor or towing vehicle brakes, disengage the PTO, shut off the engine and **remove the ignition key**.
- Be especially observant of the operating area and terrain - watch for holes, rocks or other hidden hazards. Always inspect the area prior to operation.
  - **DO NOT** operate near the edge of drop-offs or banks.
  - **DO NOT** operate on steep slopes as overturn may result.
  - Operate up and down (not across) intermediate slopes. Avoid sudden starts and stops.



## HIGHWAY AND TRANSPORT OPERATIONS

- Adopt safe driving practices:
  - Keep the brake pedals latched together at all times. **NEVER USE INDEPENDENT BRAKING WITH MACHINE IN TOW AS LOSS OF CONTROL AND/OR UPSET OF UNIT CAN RESULT.**
  - Always drive at a safe speed relative to local conditions and ensure that your speed is low enough for an emergency stop to be safe and secure. Keep speed to a minimum.
  - Reduce speed prior to turns to avoid the risk of overturning.
  - Avoid sudden uphill turns on steep slopes.
  - Always keep the tractor or towing vehicle in gear to provide engine braking when going downhill. Do not coast.
  - Do not drink and drive!
- Comply with state and local laws governing highway safety and movement of farm machinery on public roads.
- Use approved accessory lighting flags and necessary warning devices to protect operators of other vehicles on the highway during daylight and nighttime transport. Various safety lights and devices are available from your dealer.
- The use of flashing amber lights is acceptable in most localities. However, some localities prohibit their use. Local laws should be checked for all highway lighting and marking requirements.
- When driving the tractor and equipment on the road or highway under 40 kph (20 mph) at night or during the day, use flashing amber warning lights and a slow moving vehicle (SMV) identification emblem.
- Plan your route to avoid heavy traffic.

- Be a safe and courteous driver. Always yield to oncoming traffic in all situations, including narrow bridges, intersections, etc.
- Be observant of bridge loading ratings. Do not cross bridges rated lower than the gross weight as which you are operating.
- Watch for obstructions overhead and to the side while transporting.
- Always operate equipment in a position to provide maximum visibility at all times. Make allowances for increased length and weight of the equipment when making turns, stopping the unit, etc.
- Pick the levellest possible route when transporting across fields. Avoid the edges of ditches or gullies and steep hillsides.
- Be extra careful when working on inclines.
- Maneuver the tractor or towing vehicle at safe speeds.
- Avoid overhead wires or other obstacles. Contact with overhead lines could cause serious injury or death.
- Avoid loose fill, rocks and holes; they can be dangerous for equipment operation or movement.
- Allow for unit length when making turns.
- Operate the towing vehicle from the operator's seat only.
- Never stand alongside of unit with engine running or attempt to start engine and/or operate machine while standing alongside of unit.
- Never leave running equipment attachments unattended.
- As a precaution, always recheck the hardware on equipment following every 100 hours of operation. Correct all problems. Follow the maintenance safety procedures.



## FOLLOWING OPERATION

- Following operation, or when unhitching, stop the tractor or towing vehicle, set the brakes, disengage the PTO and all power drives, shut off the engine and **remove the ignition keys**.
- Clean, inspect, service and make necessary repairs to the equipment when parking it for long periods of time or at the end of a working season. This will help ensure that the unit will be ready for use the next time you hook up to it.
- Store the unit in an area away from human activity.
- Do not park equipment where it will be exposed to livestock for long periods of time. Damage and livestock injury could result.
- Do not permit children to play on or around the stored unit.
- Make sure all parked machines are on a hard, level surface and engage all safety devices.

- Wheel chocks may be needed to prevent unit from rolling.



## PERFORMING MAINTENANCE

- Do not allow anyone to perform maintenance on this equipment who has not been properly trained in its safe operation.

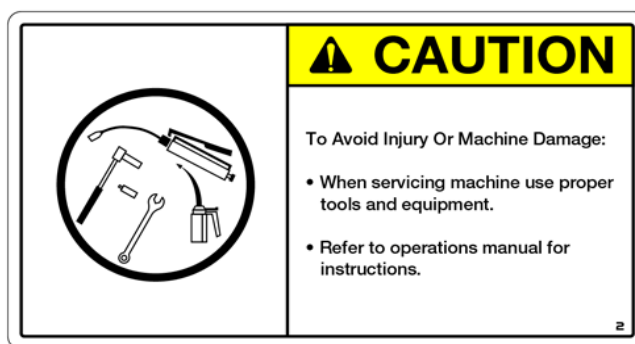

- Good maintenance is your responsibility. Poor maintenance is an invitation to trouble. Proper servicing and adjustments are key to the long life of any implement. With careful inspection and routine maintenance, costly downtime and repairs can be avoided.
- Some parts and assemblies can be quite heavy. Before attempting to unfasten any part or assembly, arrange to support it by means of a hoist, by blocking or by use of an adequate arrangement to keep it from falling, tipping, swinging or moving in any manner which may hurt somebody or damage the equipment.
- Always use lifting equipment that is adequately rated to do the job. Never lift equipment over people.
- Make sure there is plenty of ventilation. Never operate the engine of the towing vehicle in a closed building. The exhaust fumes may cause asphyxiation.
- Before working on the equipment, stop the towing vehicle, set the brakes, disengage the PTO and all power drives, shut off the engine and **remove the ignition keys**.
- Be certain all moving parts on attachments have come to a complete stop before attempting to perform maintenance.
- **Always** use a safety support and block the wheels. Never use a jack to support the equipment.
- Always use the proper tools or equipment for the job at hand.
- Use extreme caution when making adjustments.



- Never replace hex bolts with less than grade five bolts unless otherwise specified.
- After servicing, be sure all tools, parts and service equipment are removed.
- Where replacement parts are necessary for periodic maintenance and servicing, genuine factory replacement parts must be used to restore your equipment to original specifications. The manufacturer will not claim responsibility for use of unapproved parts and/or accessories and other damages as a result of their use.
- If equipment has been altered in any way from original design, the manufacturer does not accept any liability for injury or warranty.
- Do not alter the equipment or replace parts with other brands. Doing so can cause the equipment to perform improperly and may lead to breakage causing bodily injury or death.



- If repairs require the use of a torch or electric welder, be sure that all flammable and combustible materials are removed.
- Do not weld or cut on any tank containing oil, fuel or their fumes or other flammable material, or any container whose previous contents are unknown.
- Cleaning solvents should be used with care. Petroleum based solvents are flammable and present a fire hazard. Don't use gasoline. All solvents must be used with adequate ventilation and their vapors should not be inhaled.

## Transportation Lock Pin

Be sure to insert and use the transportation lock pin (shown in Figure 1) when transporting the unit from field to field. This will ensure the wings do not fall in the event of hydraulic failure. **NOTE: Make sure to remove the lock pin before lowering the wings into the field position!!!!**

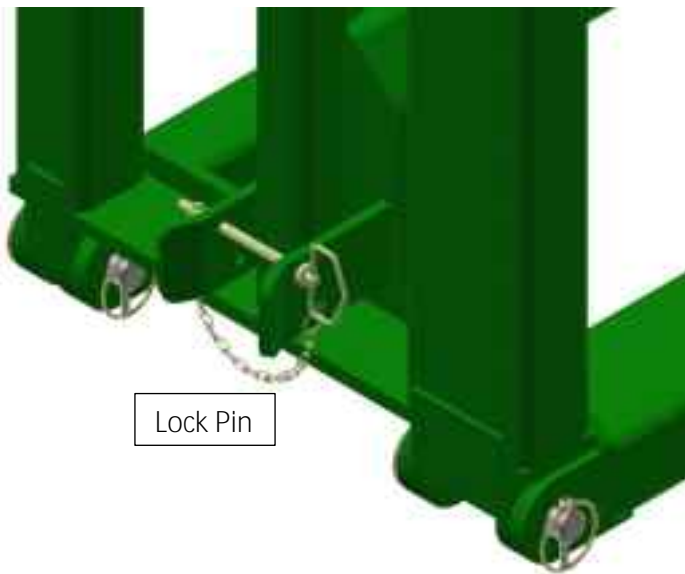

**Figure 1.**

## Rear Stabilizer Adjustment

Make sure to adjust the rear stabilizer assemblies on your Single Disc Bedder unit to engage the ground in the furrow created by the disc gangs. Adjustment of the vertical alignment is done with the turn buckle shown in **Figure 2**. Horizontal adjustment of the coulter blade is done by adjusting the axle in or out, shown in **Figure 3**. After final adjustments, make sure to tighten the jam nut of the turn buckle or the axle keeper bolts as necessary.



Figure 2

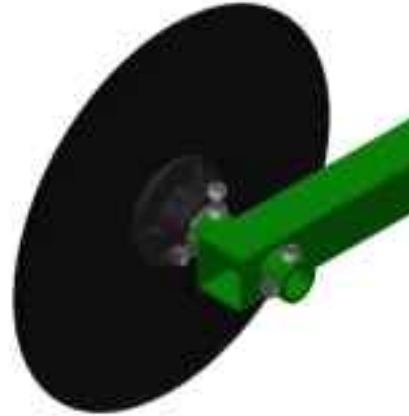

Figure 3

## Gauge Wheel Adjustment

Make sure to adjust the gauge wheel assemblies on your Single Disc Bedder unit to engage the ground in the furrow in front of the disc gangs. Adjustment of the vertical alignment is done with the turn buckle shown in **Figure 4**. Horizontal adjustment of the wheel assembly is done by adjusting the axle in or out, shown in **Figure 5**. After final adjustments, make sure to tighten the jam nut of the turn buckle or the axle keeper bolts as necessary.



Figure 4

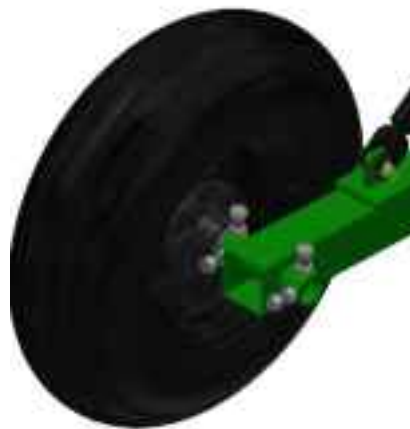

Figure 5

## Wing Leveling Adjustment

To make sure that the disc gangs all engage the ground correctly, the wings on the Single Disc Bedder unit must be level with the center portion of the frame assembly. This correction is done by making an adjustment to the attachment eye bolt on the wings where the cylinder attaches to the wings (shown in **Figure 6**). The adjustments are as follows:

- To **raise** the wing, loosen the jam nut and turn the adjustment nut **clockwise**.
- To **lower** the wing, loosen the jam nut and turn the adjustment nut **counter-clockwise**.

After making the adjustment and leveling the wings, make sure to tighten the jam nut to ensure the wings do not lose their adjustment.

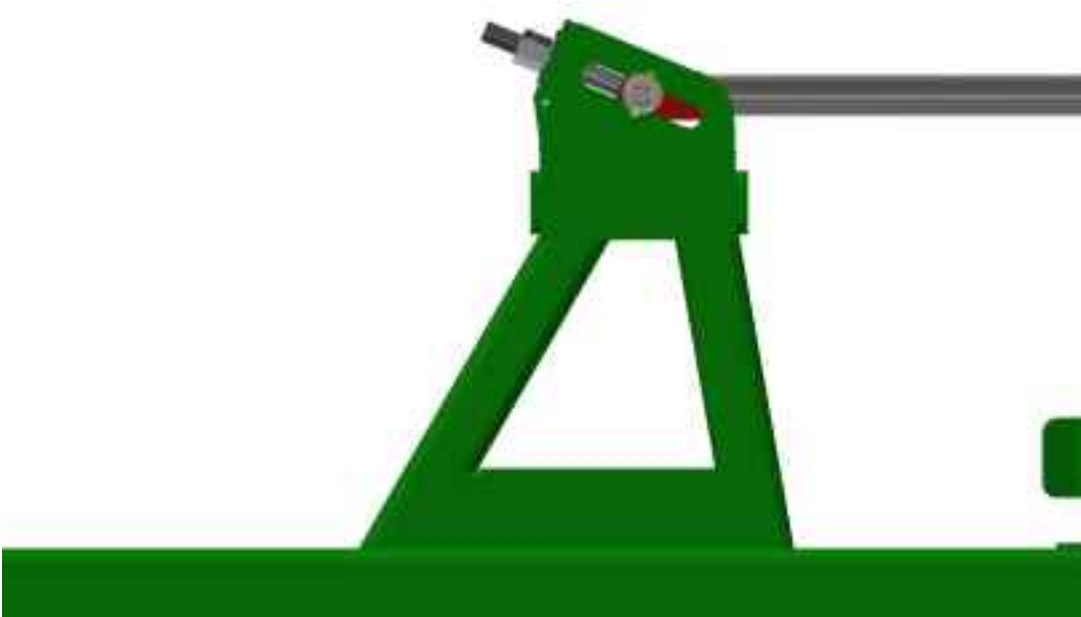

**Figure 6**

## Spare Parts Breakdown & Ordering

To have the best equipment possible, only Genuine BIGHAM Parts should be ordered. To fulfill all parts needs by both the Dealer and the Farmer, BIGHAM has a very capable and friendly parts department at both our Carlisle, AR and Lubbock, TX locations. When replacement parts are required, please call into either location with the Genuine BIGHAM part numbers listed in the sections below. Contact information for both sites is as follows:

BIGHAM AG – Carlisle  
1200 E. Durkee St.  
Carlisle, AR 72024  
Phone: (870) 552-7518

BIGHAM AG – Lubbock  
705 East Slaton Road  
P.O. Box 3338  
Lubbock, TX 79452  
Phone: (806) 745-0384

Remember when ordering to have the Model number and Serial of your unit ready to ensure that the proper part revisions are ordered for your specific BIGHAM Single Disc Bedder Implement. All part numbers necessary for each piece of equipment are shown below in the specific item parts breakdowns.

## SDB38 & SDB40 FRAME HITCH COMPONENTS

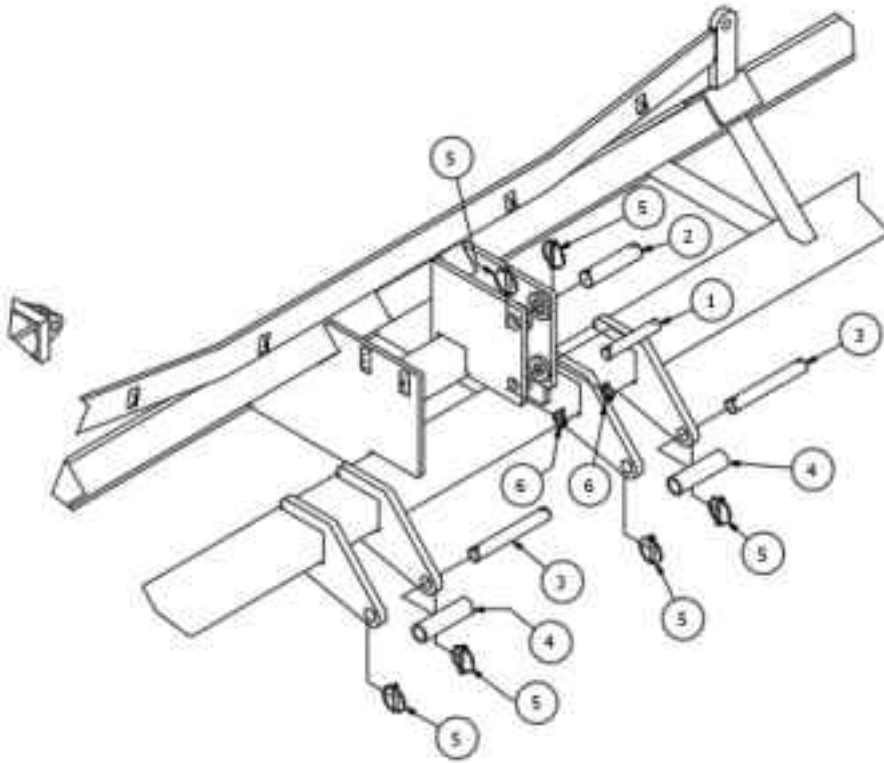

SDB38 & SDB40 Frame Hitch Assembly Components P/N: 702-410			
Reference Number	Part Number	Description	Required Quantity per Assembly
1	H617-190	Cat 3 Top Link Hitch Pin	1
2	H617-191	Cat 4 Top Link Hitch Pin	1
3	H617-196	Cat 3/4 Bottom Hitch Pin	2
4	H312-404	Cat 4 Bottom Hitch Pin Spacer Sleeve	2
5	H230-123	7/16" Lynch Pin	6
6	H617-104	5/16" Lynch Pin	2

## FRAME WING ASSEMBLY COMPONENTS

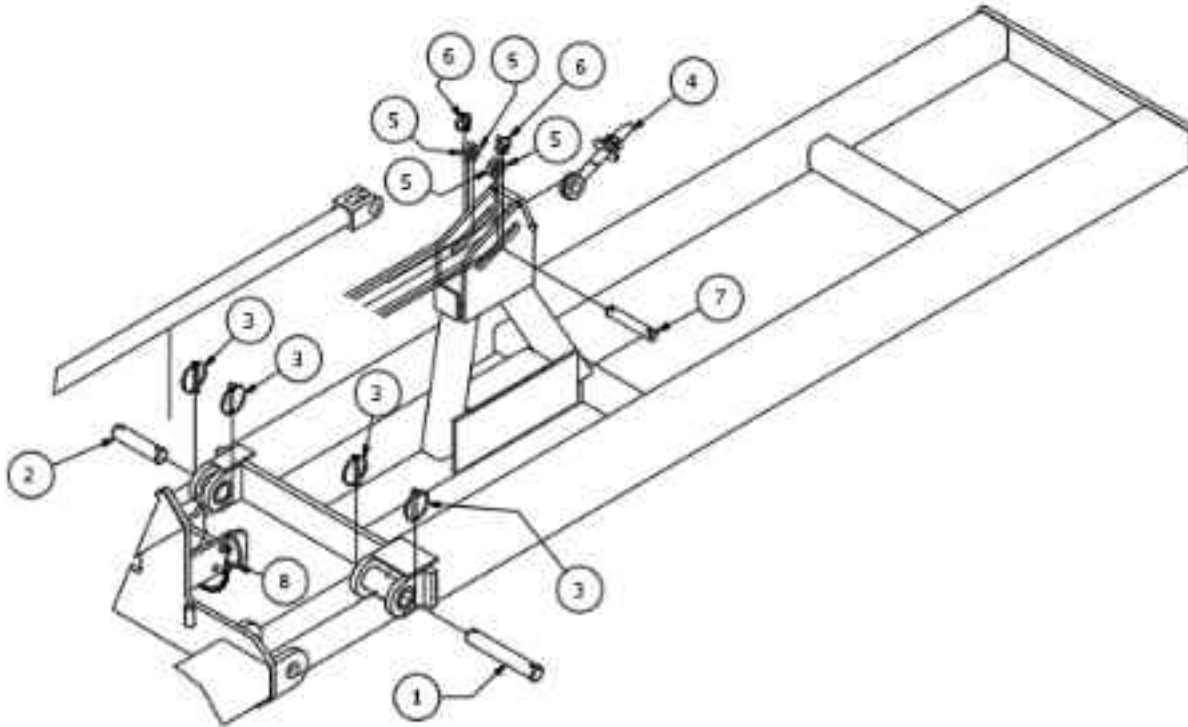

SDB38 Wing Assemblies P/N: 702-413/414 & SDB40 Wing Assemblies P/N: 702-411/412			
Reference Number	Part Number	Description	Required Quantity per Unit
1	320-413	Wing Front Hinge Pin (9" Long)	2
2	320-414	Wing Rear Hinge Pin (6" Long)	2
3	H230-123	7/16" Lynch Pin	8
4	823-075	Cylinder Eyebolt Leveling Assembly	2
5	616-1600Z	1" Zinc Plated Flat Washer	4
6	H617-104	5/16" Lynch Pin	2
7	617-188	Cylinder Eyebolt Attachment Pin	2
8	617-132	Transportation Lock Pin - (1/2" Dia.)	2

## Single Disc Bedder Disc Gang Assemblies

The Disc Gang Assemblies on the BIGHAM Single Disc Bedder are common to all models. These gangs have been designed and fabricated to the BIGHAM standard of quality to ensure that our customers have the highest quality components possible. Below is the Parts breakdown for each of the Disc Gang Assembly variations. Please ensure to check your Disc Gang assemblies before use to make sure that all components are fully ready for each use.

### Left Hand Disc Gang Assembly

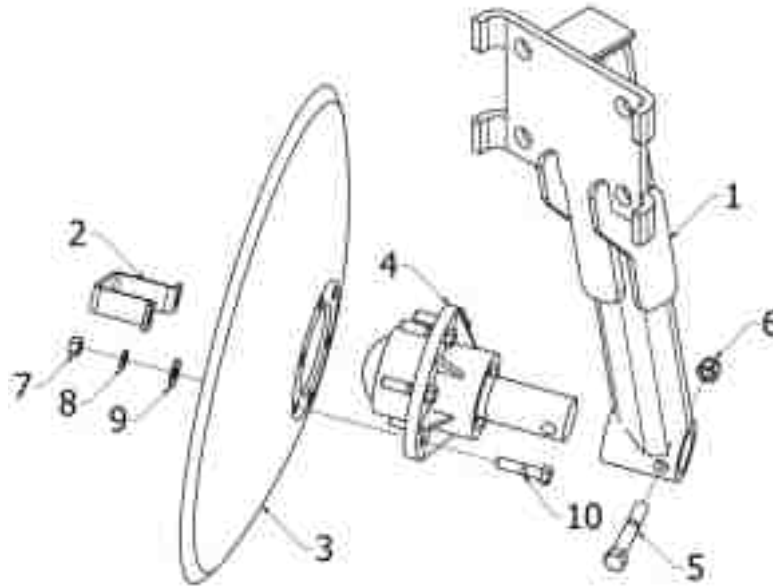

SDB LH Disc Gang Assembly P/N: 785-404			
Reference Number	Part Number	Description	Required Quantity per Assembly
1	687-404	SDB LH Disc Gang Weldment	1
2	320-435	Hub Dust Cap Keeper	1
3	630-024FC6	24" Notched Disc Blade or Smooth Blade (shown)	1
4	627-162C	SDB Gang/Stabilizer Wheel Hub Assembly	1
5	602-1016Z	5/8" Grade 5 Zinc Plated Bolt x 4" Long	1
6	613-1000Z	5/8" Grade 5 Zinc Plated Nylock Nut	1
7	611-0801Z	1/2" Grade 5 Zinc Plated Hex Nut	6
8	615-0800Z	1/2" Zinc Plated Lock Washer	6
9	611-0800Z	1/2" Zinc Plated Flat Washer	6
10	200243	Bolt, Hex 1/2" x 2-1/4" Grade 8	6



## Right Hand Disc Gang Assembly

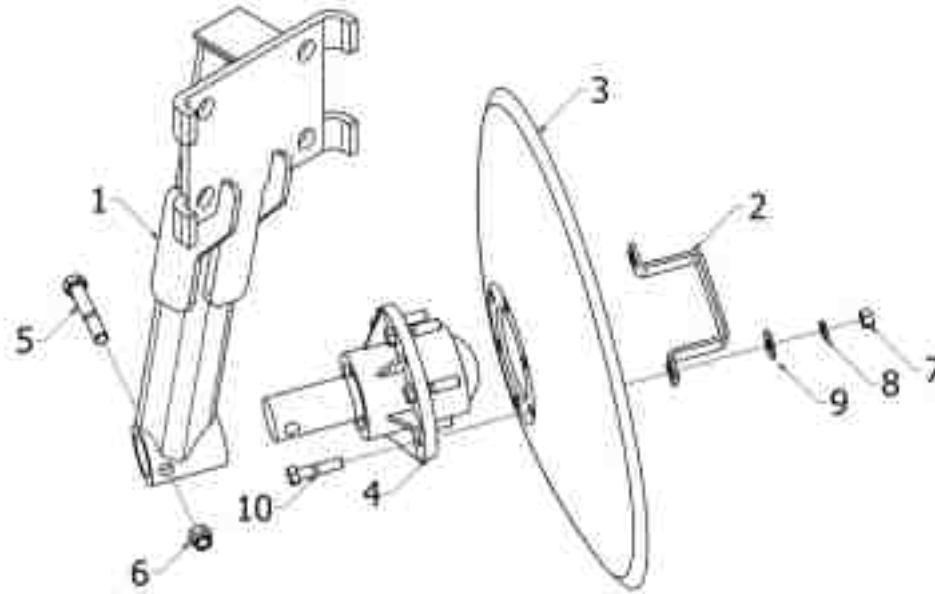

SDB RH Disc Gang Assembly P/N: 785-405			
Reference Number	Part Number	Description	Required Quantity per Assembly
1	687-405	SDB RH Disc Gang Weldment	1
2	320-435	Hub Dust Cap Keeper	1
3	630-024FC6	24" Notched Disc Blade or Smooth Blade (shown)	1
4	627-162C	SDB Gang/Stabilizer Wheel Hub Assembly	1
5	602-1016Z	5/8" Grade 5 Zinc Plated Bolt x 4" Long	1
6	613-1000Z	5/8" Grade 5 Zinc Plated Nylock Nut	1
7	611-0801Z	1/2" Grade 5 Zinc Plated Hex Nut	6
8	615-0800Z	1/2" Zinc Plated Lock Washer	6
9	611-0800Z	1/2" Zinc Plated Flat Washer	6
10	200243	Bolt, Hex 1/2" x 2-1/4" Grade 8	6

## 16R30 Right Hand Disc Gang Assembly

Due to the shorter spacing of the gangs on a 16 row 30 configuration, the gang to the right of the hitch is slightly different than a standard RH Disc Gang Assembly to allow for clearance around the hitch plates. The Parts breakdown for this specific assembly is below.

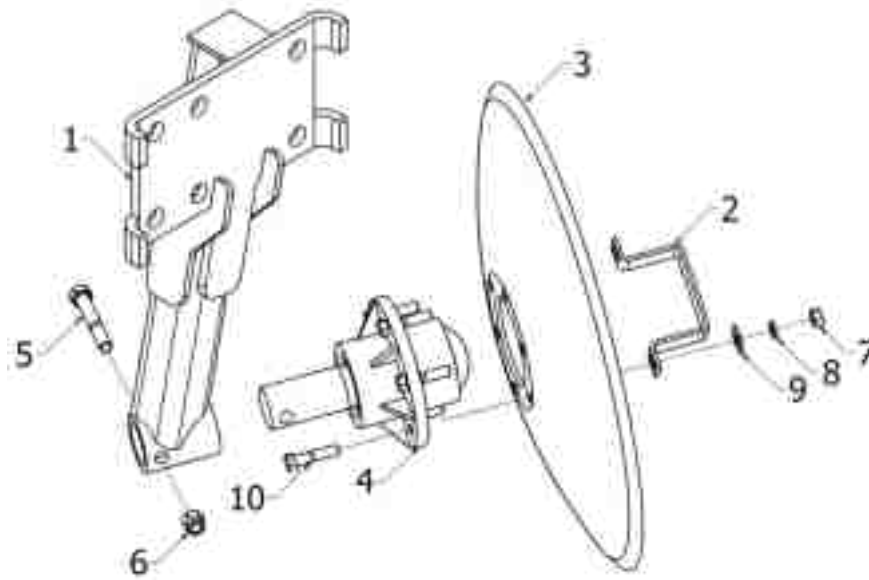

SDB 16R30 RH Disc Gang Assembly P/N: 785-406			
Reference Number	Part Number	Description	Required Quantity per Assembly
1	687-406	SDB 16R30 RH Disc Gang Weldment	1
2	320-435	Hub Dust Cap Keeper	1
3	630-024FC6	24" Notched Disc Blade or Smooth Blade (shown)	1
4	627-162C	SDB Gang/Stabilizer Wheel Hub Assembly	1
5	602-1016Z	5/8" Grade 5 Zinc Plated Bolt x 4" Long	1
6	613-1000Z	5/8" Grade 5 Zinc Plated Nylock Nut	1
7	611-0801Z	1/2" Grade 5 Zinc Plated Hex Nut	6
8	615-0800Z	1/2" Zinc Plated Lock Washer	6
9	611-0800Z	1/2" Zinc Plated Flat Washer	6
10	200243	Bolt, Hex 1/2" x 2-1/4" Grade 8	6

# Single Disc Bedder Rear Stabilizing Coultter Assembly

The stabilizer arm weldment is reversible for left and right offsets. Refer to the row spacing layout section for correct orientation for each stabilizer assembly.

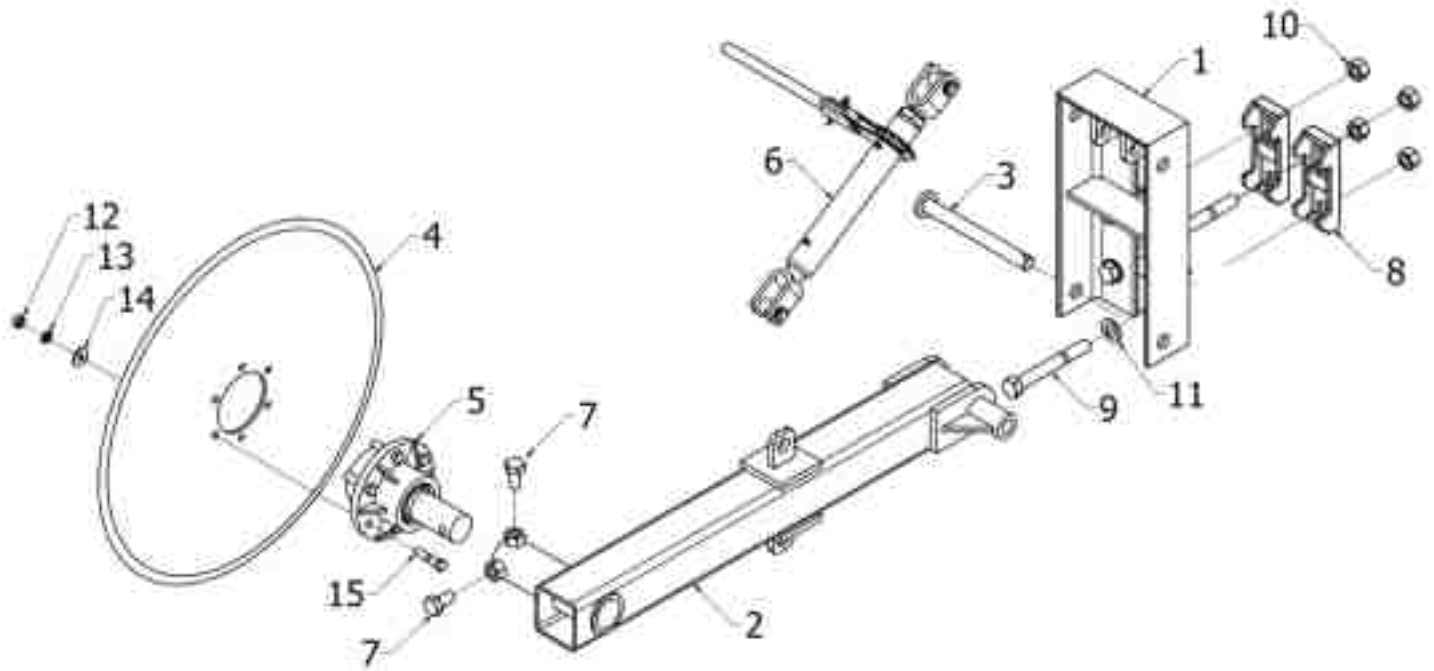

SDB Rear Stabilizer Assembly P/N: 785-401			
Reference Number	Part Number	Description	Required Quantity per Assembly
1	687-401	SDB Stabilizer Frame Weldment	1
2	687-402	SDB Stabilizer Arm Weldment	1
3	687-403	SDB Stabilizer Pivot Pin Weldment	1
4	630-048	28" Flat Coultter	1
5	627-162C	SDB Gang/Stabilizer Wheel Hub Assembly	1
6	705-080	Dual Yoke Turn Buckle Assembly w/ Pins	1
7	602-1206Z	3/4" Gr. 5 Zinc Plated Bolt X 1 1/2" Long	4
8	628-400	4" Clamp Cap	2
9	602-1428Z	7/8" GR. 5 Zinc Plated Bolt X 7" Long	4
10	611-1401Z	7/8" GR. 5 Zinc Plated Nut	4
11	616-1400Z	7/8" Zinc Plated Flat Washer	4
12	611-0801Z	1/2" Grade 5 Zinc Plated Hex Nut	6
13	615-0800Z	1/2" Zinc Plated Lock Washer	6
14	611-0800Z	1/2" Zinc Plated Flat Washer	6
15	200243	Bolt, Hex 1/2" x 2-1/4" Grade 8	6

## Single Disc Bedder Dirt Shield Assemblies

The Dirt shields on this BIGHAM Single Disc Bedder Implement are designed to keep the dirt being moved by the disc Gangs centered on the row being created. Ensure before use that these shields are in the center of the opposing disc gangs to keep the functionality at an optimum level.

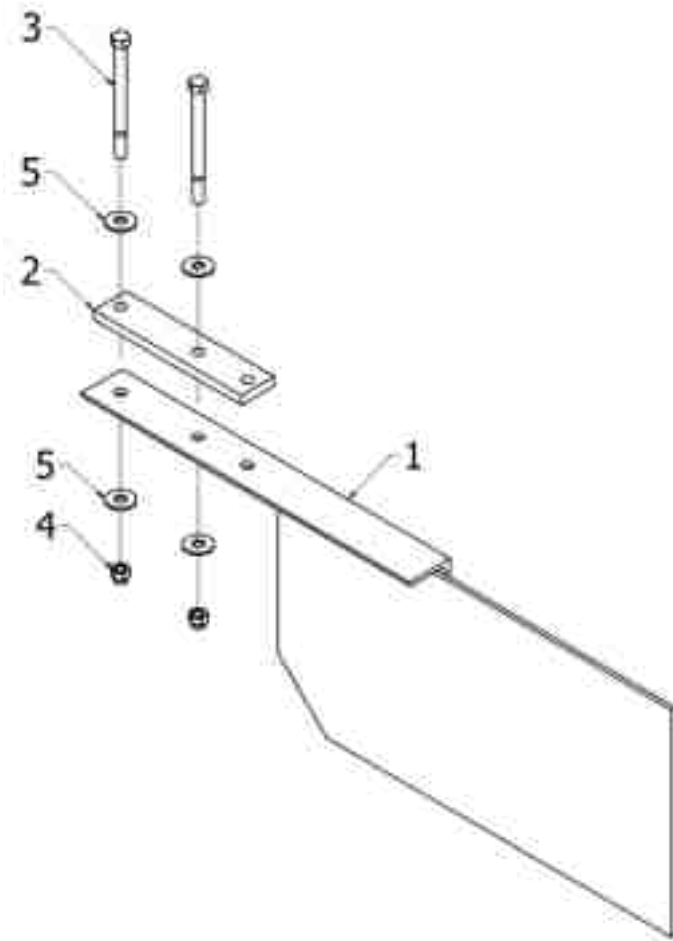

SDB Dirt Shield Assembly P/N: 785-400			
Reference Number	Part Number	Description	Required Quantity per Assembly
1	687-400	SDB Dirt Shield Weldment	1
2	320-411	SDB Dirt Shield Clamp Plate	1
3	602-0824Z	1/2" GR. 5 Zinc Plated Bolt x 6" Long	2
4	613-0800Z	1/2" Gr. 5 Zinc Plated Nylock Nut	2
5	616-0800Z	1/2" Zinc Plated Flat Washer	4

## Left-Hand Dirt Shield Assembly (8.25" Offset)

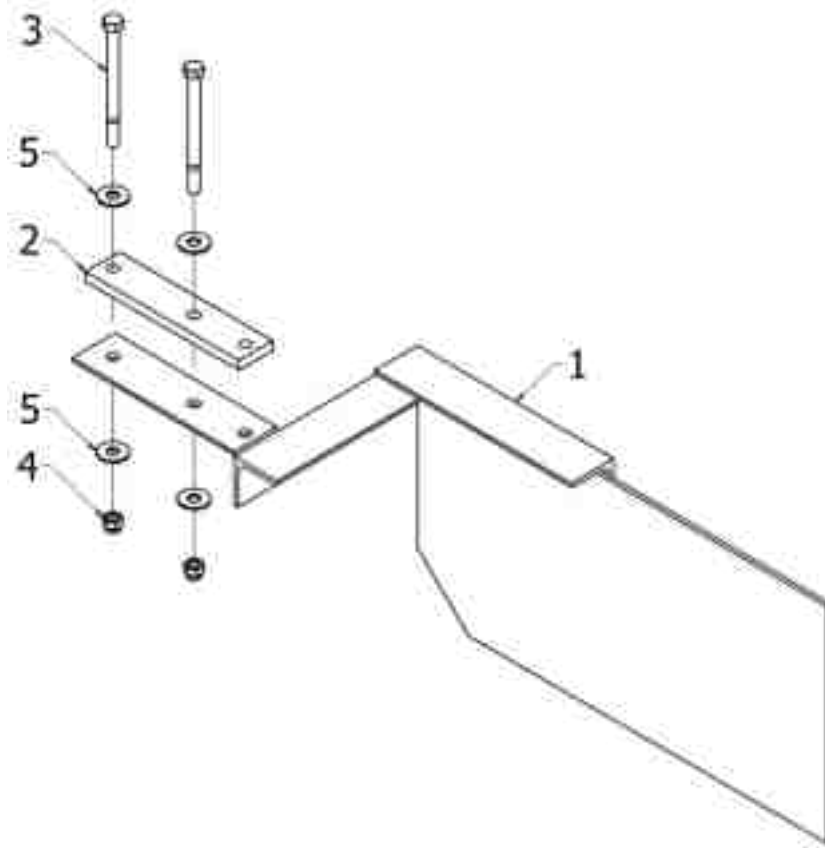

SDB Dirt Shield Assembly P/N: 785-400-LH			
Reference Number	Part Number	Description	Required Quantity per Assembly
1	687-400-LH	SDB Dirt Shield Weldment – LH Offset	1
2	320-411	SDB Dirt Shield Clamp Plate	1
3	602-0824Z	1/2" GR. 5 Zinc Plated Bolt x 6" Long	2
4	613-0800Z	1/2" Gr. 5 Zinc Plated Nylock Nut	2
5	616-0800Z	1/2" Zinc Plated Flat Washer	4

## Right-Hand Dirt Shield Assembly (6.5" Offset)

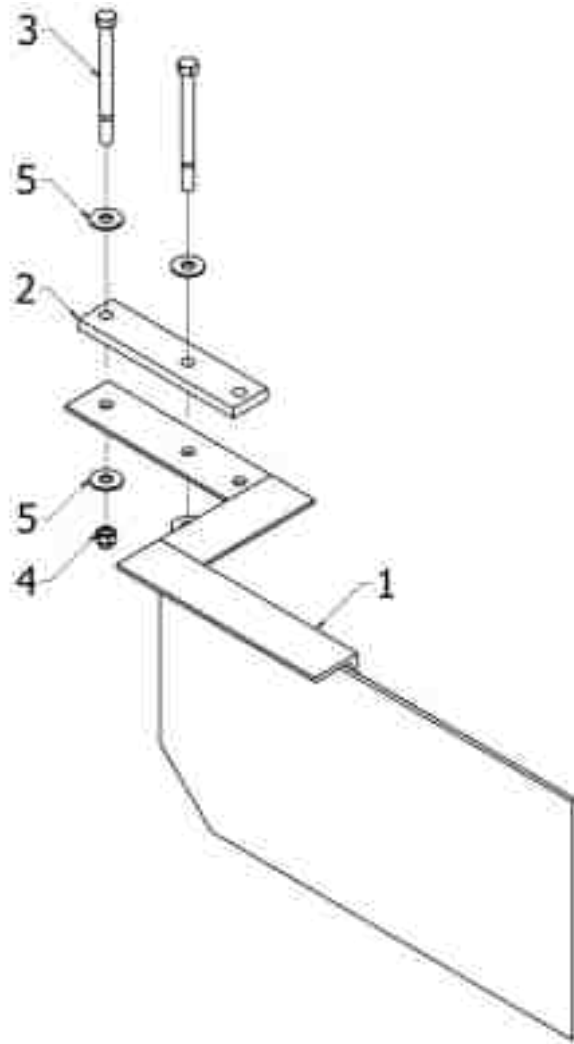

SDB Dirt Shield Assembly P/N: 785-400-RH			
Reference Number	Part Number	Description	Required Quantity per Assembly
1	687-400-RH	SDB Dirt Shield Weldment – RH Offset	1
2	320-411	SDB Dirt Shield Clamp Plate	1
3	602-0824Z	1/2" GR. 5 Zinc Plated Bolt x 6" Long	2
4	613-0800Z	1/2" Gr. 5 Zinc Plated Nylock Nut	2
5	616-0800Z	1/2" Zinc Plated Flat Washer	4

# BIGHAM Universal Gauge Wheel Assembly

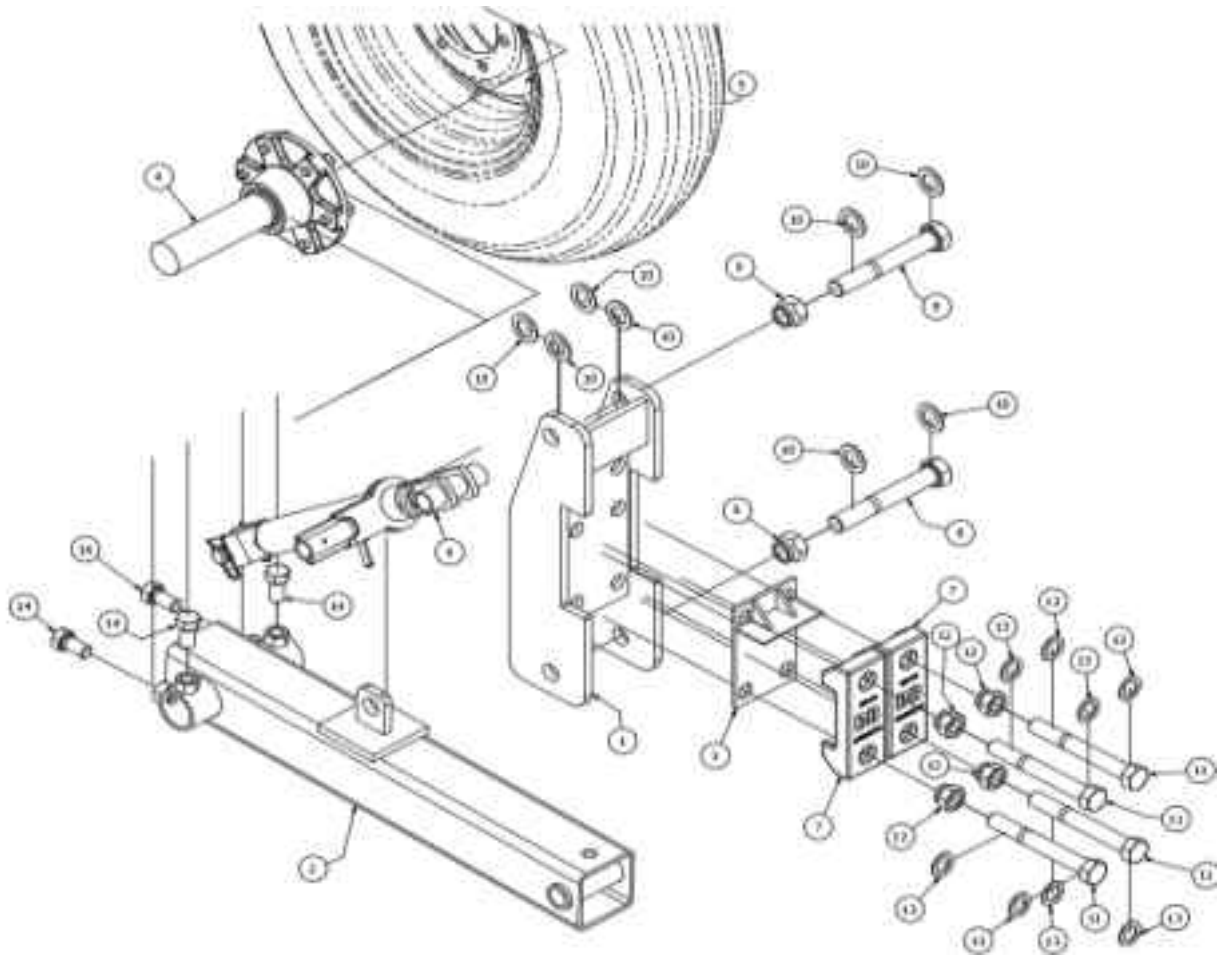

BIGHAM Universal Gauge Wheel Assembly (4" X 4" Tube Configuration) P/N: 855-444			
Reference Number	Part Number	Description	Required Quantity per Assembly
1	H705-000	Universal Gauge Wheel Mount Bracket	1
2	H705-001	Universal Gauge Wheel Arm Weldment	1
3	H705-002	UGW 4" Tube adapter Weldment	1
4	627-161	Gauge Wheel Hub Assembly W/ 2" Spindle	1
5	627-567	Wheel & Tire Assembly (order separately)	1
6	705-083	Yoke/Tube Adjustment Turn Buckle	1
7	628-400	4" Clamp Cap	2
8	602-1628Z	1" GR. 5 Zinc Plated Bolt X 7" Long	2
9	613-1600Z	1" GR. 5 Zinc Plated Nylock Nut	2
10	616-1600Z	1" Zinc Plated Flat Washer	8
11	602-1428Z	7/8" GR. 5 Zinc Plated Bolt X 7" Long	4
12	611-1401Z	7/8" GR. 5 Zinc Plated Nut	4
13	616-1400Z	7/8" Zinc Plated Flat Washer	4
14	602-1206Z	3/4" GR. 5 Zinc Plated Bolt X 1 1/2"	4

# HYDRAULIC HOSE ASSEMBLIES –

Each BIGHAM Ag implement has a specifically designed hydraulic hose system. These systems are designed to allow the specific implements to operate at the optimum level. The system for both the SDB40 & the SDB38 Single Disc Bedder Assembly are identical. Below is the breakdown of the hydraulic layout.

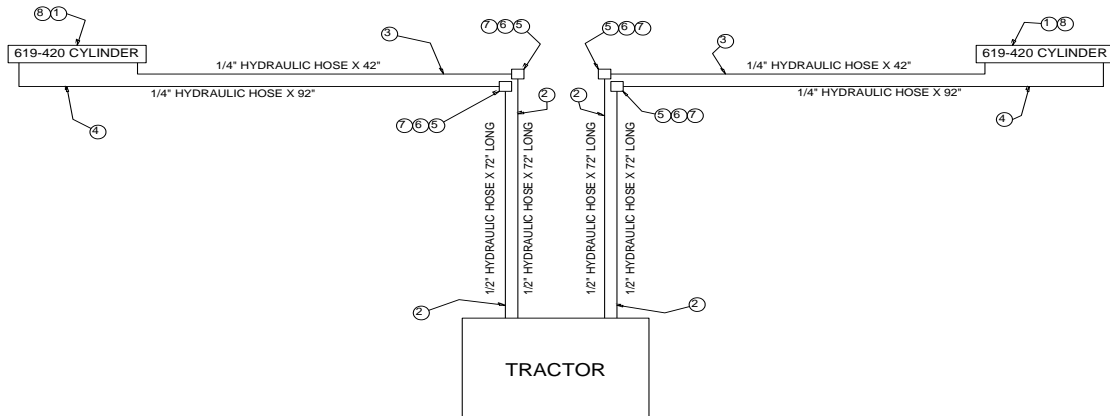

SDB Hydraulic Assembly			
Reference Number	Part Number	Description	Required Quantity per Assembly
1	619-420	Wing Lift Hydraulic Cylinder W/ Pins	2
2	1/2" Hyd. Hose Assembly X 72" Long		4
	H620-321	1/2" Hyd. Hose (72" Long each)	
	H620-181	1/2" Hose End x 3/4" Orb Male Fitting	
	620-641	Hose Fitting, #8 - 8JIC	
	H621-145	Hyd. Coupling, Quick Disconnect	
3	1/4" Hyd. Hose Assembly X 42" Long		2
	H620-319	1/4" Hyd. Hose (42" Long Each)	
	H620-152	Hose End, 3/8" FJIC X 1/4" Hose (2 per)	
4	1/4" Hyd. Hose Assembly X 92" Long		2
	H620-319	1/4" Hyd. Hose (92" Long Each)	
	H620-152	Hose End, 3/8" FJIC X 1/4" Hose (2 per)	
	Other Required Fittings		
5	621-052	Elbow, #8MJ to #8MJ	4
6	621-105	Nut, 3-Piece 1/2"	4
7	621-104	Reducer, 8FJ - 6MJ	4
8	624-054	Cylinder Fitting, #8MB - #6MJIC	4





12 Row 36" – SDB38

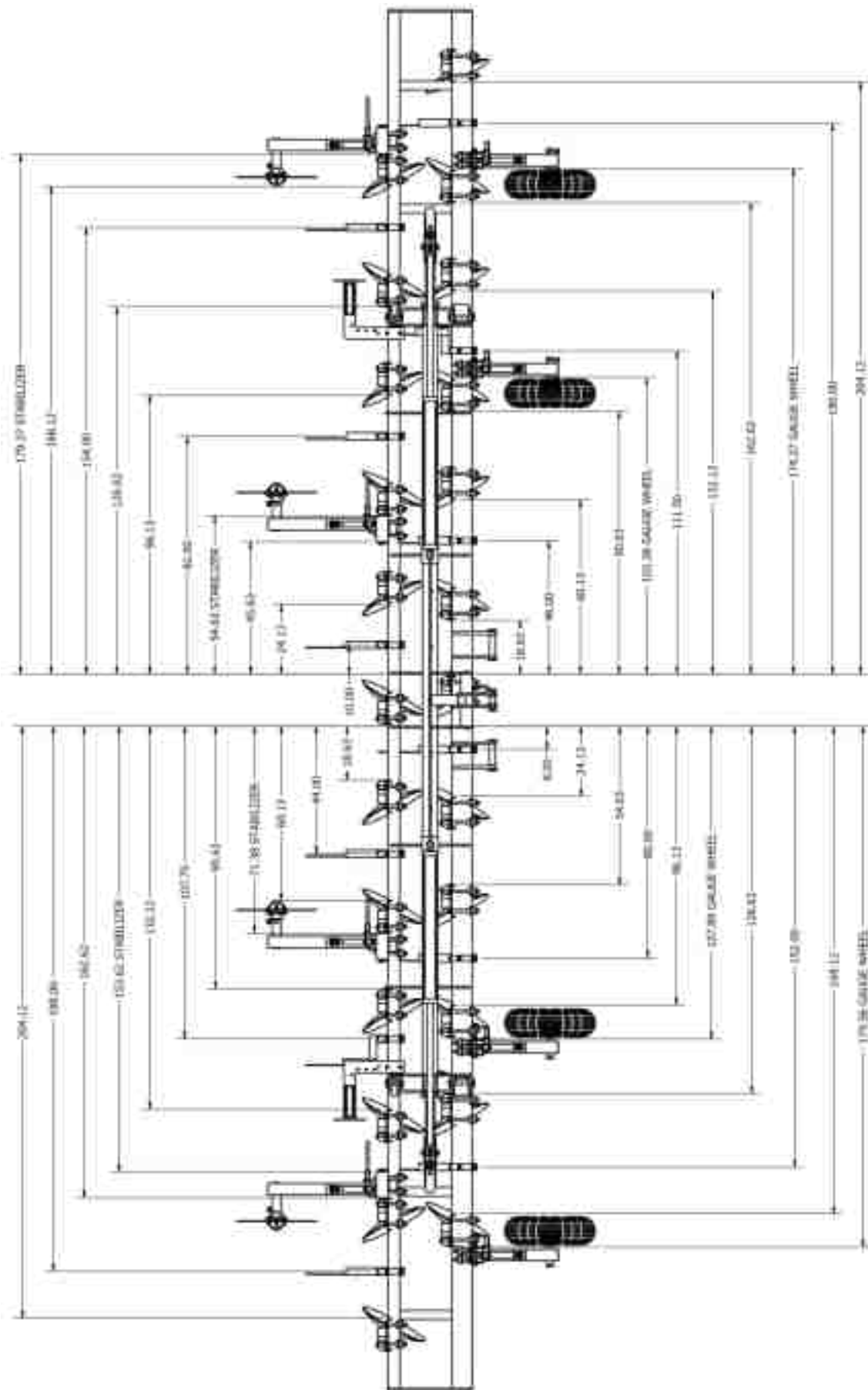

12 Row 38" (both SDB38 & SDB40) – Shown below as SDB38.

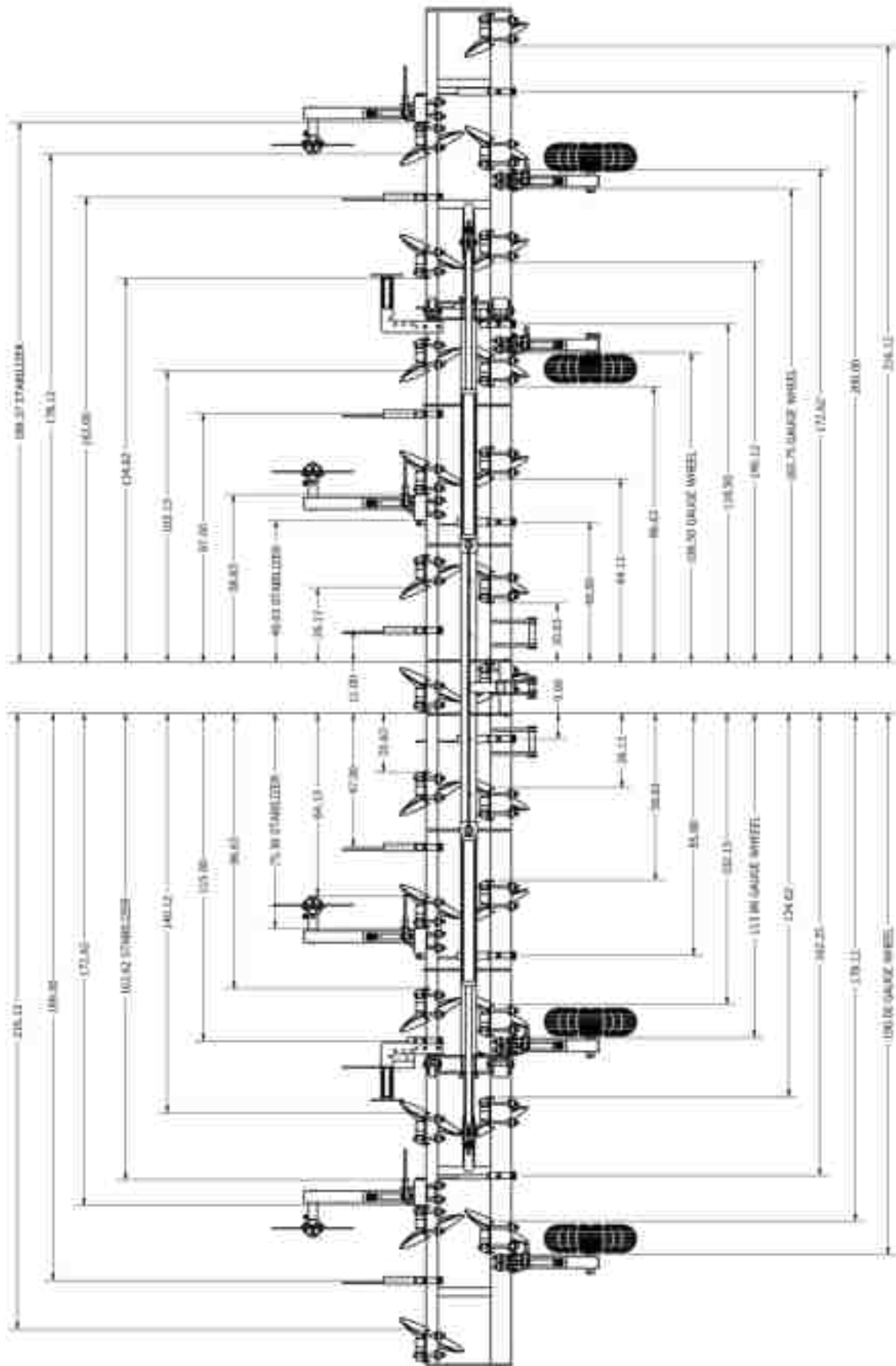





# MAINTENANCE CHART

ITEM	INTERVAL
Check tire pressure.	Before running.
Grease wheel bearings.	Two times per year.
Grease rolling element bearings.	After running. Every 2-3 days of use.
Grease frame hinges	Daily.
Review safety instructions.	Annually.
Clean implement.	As needed.
Clean and paint.	As needed.



## ASSISTANCE

If you have questions not answered in this manual, or require additional copies, or the manual is damaged, please contact your dealer or:

Bigham Ag

Customer Service Department

1220 E Durkee Street, Carlisle, AR 72024

Phone: 870-552-7517

Fax: 870-552-3303